

SUL 181 d

Analogue time switch with daily program



The analogue SUL 181 d, which has been tried and tested over many years, can be programmed exactly thanks to 15 minute segments and has a manual switching pre-selection option.

SUL 181 d
1810011



Precise setting

The clear time with 12/24-hour display (no confusion between 9:00 and 21:00, for example), clock hand and program setting in 15 minute segments make operation child's play.



Intervene manually at any time

With three settings: PERM ON/AUTO/PERM OFF. The time program can be turned off manually at any time if required; e.g. in the event of repair, tests or holidays.



More accurate: quartz controlled

The main advantage of a quartz-controlled time switch is its time accuracy. For the SUL 181 d, this is ± 1 s/day at 20 °C and the power reserve is 200 hours (approx. 100 hours at 110 V).



DuoFix plug-in terminals

These make it possible to connect two conductors (wire or strand) easily, reducing the installation time and costs. Removing the wires is also not a problem – press down with a screwdriver, pull out the conductor, done. It couldn't be easier.



Reliable: install and forget

Our time switches run and run and run. To exaggerate, this means: install and forget. Due to the high testing requirements in our in-company laboratory with, for example, 40,000 switching cycles, we are above the standard in parts. This demand for quality is also confirmed by an external VDE test. The brand on the outside is what is being installed!



Quality "Made in Germany"

All devices of the SUL series are developed and produced in Haigerloch. During the manufacturing process itself, the 100% final inspection ensures that each of our products leaves our company in flawless condition. Quality is something we do not take for granted.



Cadmium-free contacts

We have already been using the environmentally friendly materials for our switching contacts since the turn of the millennium. These offer comparably good, in some cases even better contact and switching properties, such as higher burn-off resistance, increased welding resistance and a significantly reduced tendency for material migration during direct current operation.

SUL 181 d

Analogue time switch with daily program

Function description

- ❗ With power reserve (NiMH rechargeable battery)
- ❗ 96 switching segments
- ❗ Quartz controlled
- Shortest switching time: 15 minutes
- Clock hand for time display and 12/24 hour recognition
- Simple summer/winter time correction
- Time can be changed clockwise or anti-clockwise
- Manual control with 3 settings: PERM ON/AUTO/PERM OFF
- Switching status display
- DuoFix load line connections for 2 conductors each
- Wire or strand (with or without crimp terminal)
- Wire diameter: 0.5–2.5 mm²
- Button for releasing plug-in connection
- Switching pre-selection

Technical data

Operating voltage	110–230 V AC
Frequency	50–60 Hz
Width	3 TE
Program	Daily program
Number of channels	1
Number of switching segments	96
Time accuracy at 20 °C	≤ ± 1 s/day (quartz)
Power reserve	200 hours
Switching capacity	16 A (at 250 V AC, cos φ = 1) 4 A (at 250 V AC, cos φ = 0.6)
Standby output	~0.5 W
Protection rating	IP 20

Wiring diagram

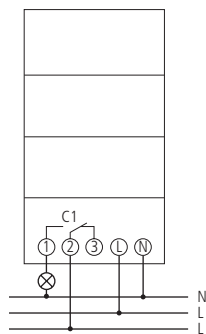

Dimension diagram

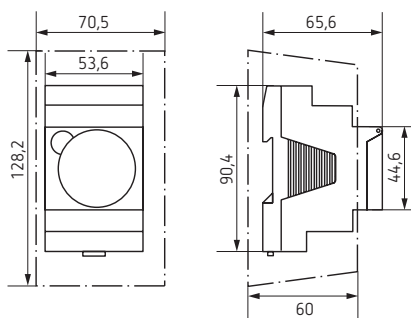

Lamp loads

- LED lamp < 2 W	20 W
- LED lamp > 8 W	180 W
- Incandescent and halogen lamp load	1100 W
- Compact fluorescent lamps	90 W

Accessories



Wall mounting kit 52.5 mm
↳ Item no.: 9070050



Front panel mounting kit
↳ Item no.: 9070001

Precise & reliable
Analogue time switches
from Theben

You can find additional analogue and digital time switches at

www.theben.de/en

Item number

SUL 181 d	Daily program	1810011	94.42
SUL 191 w	Weekly program	1910011	119.11